



The Upper Drive, Hove



Asking Price
£325,000
Leasehold

- LARGE ONE BEDROOM APARTMENT
- PRIVATE GARDEN & COMMUNAL ROOF TERRACE
- CENTRAL HOVE LOCATION
- GROUND FLOOR
- NO ONWARD CHAIN

Robert Luff & Co are delighted to bring to market this fantastic one bedroom apartment situated in the ever desirable Upper Drive. Accommodation currently offers; One bedroom, open planned kitchen/living area with a private garden and a great sized, well presented bathroom. Other benefits include underfloor heating throughout the flat, 107 years remaining on the lease and communal roof terrace.

Positioned to the south of Old Shoreham Road, The Upper Drive is only a 10 minute walk to Hove mainline station and is a short walk away from the seafront and bustling café culture, restaurants and galleries of central Hove and Brighton

T: 01273 921133 E:
www.robertluff.co.uk

**Robert
Luff & Co**
Sales | Lettings | Commercial



Accommodation

Entrance Hall

Lounge/Diner/Kitchen 24'8 x 10' (7.52m x 3.05m)

Bedroom 17'2 x 10'1 (5.23m x 3.07m)

Bathroom

Private Garden

Communal Roof Terrace

Agents Notes

Tenure: Leasehold 107 Years Remaining

Service Charge: £143.81 Per Calendar Month

EPC Rating: C

Council Tax Band: C

28 Blatchington Road, Hove, East Sussex, BN3 3YN

T: 01273 921133 E:

www.robertluff.co.uk



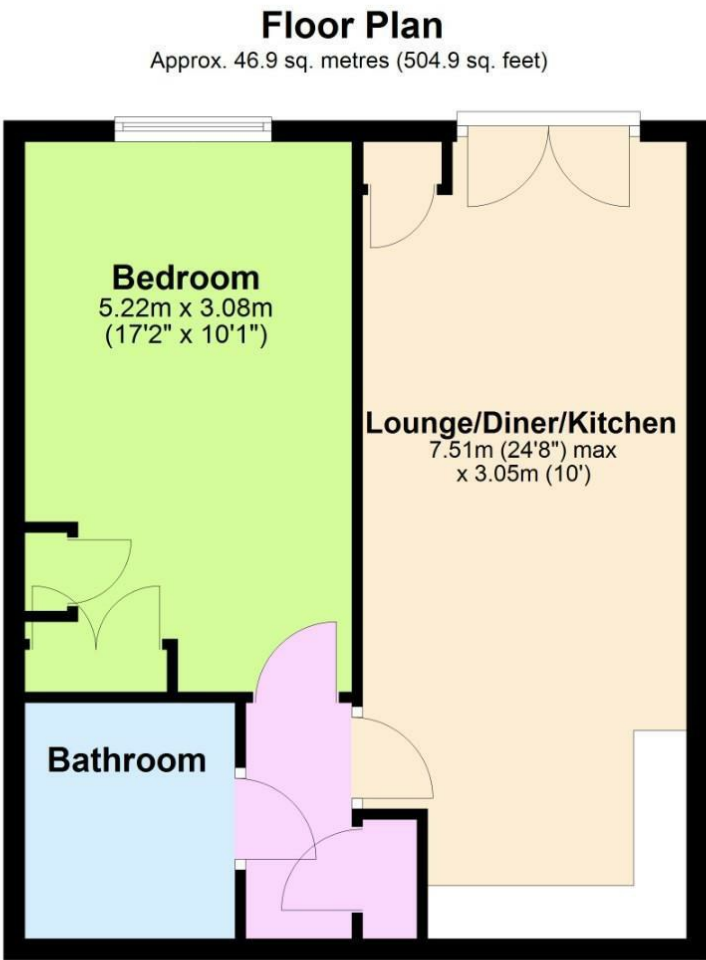

Total area: approx. 46.9 sq. metres (504.9 sq. feet)

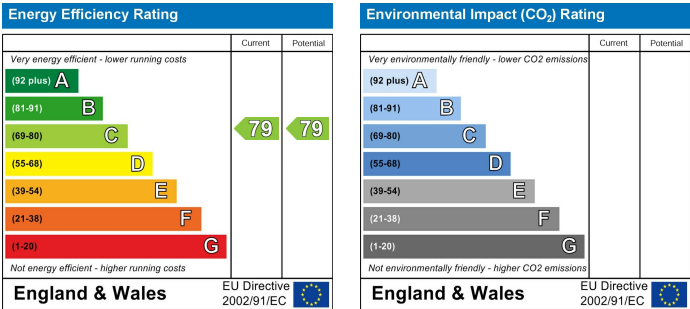

The information provided about this property does not constitute or form any part of an offer or contract, nor may it be regarded as representations. All interested parties must verify accuracy and your solicitor must verify tenure/lease information, fixtures and fittings and, where the property has been extended/converted, planning/building regulation consents. All dimensions are approximate and quoted for guidance only as are floor plans which are not to scale and their accuracy cannot be confirmed. References to appliances and/or services does not imply that they are necessarily in working order or fit for the purpose.